

24B OPTION: A

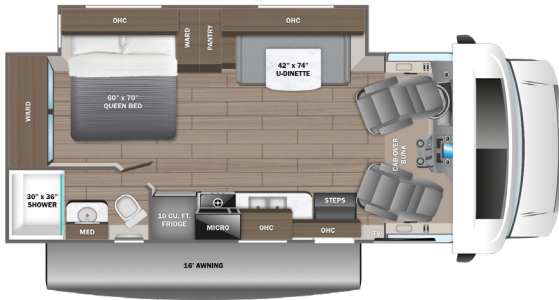

26M OPTION: A

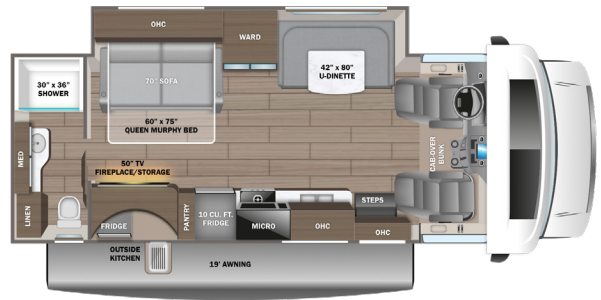

29XK OPTION: A

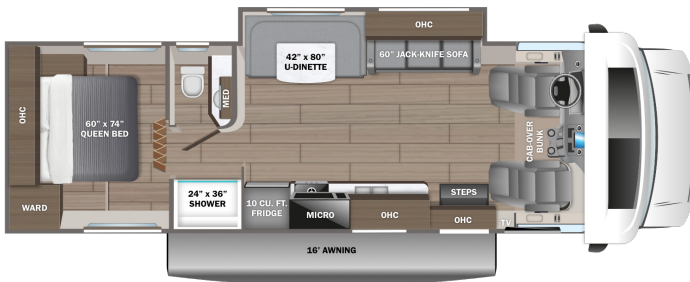

31F OPTION: A

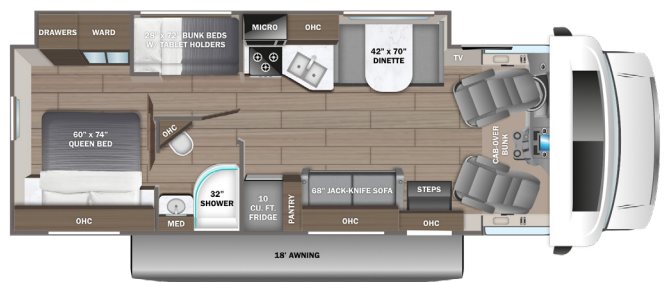

OPTION

A



Theater Sofa

## EXTERIOR SELECTION



Standard Graphics Package

# STANDARDS & OPTIONS

## CUSTOMER VALUE PACKAGE

JRide®: Computer-balanced driveshaft, standard front and rear stabilizer bars, Hellwig® helper springs, rubber isolation body mounts  
 One-piece, seamless, fiberglass front cap  
 Automotive-bonded, panoramic window in front cap with power shade  
 Heated holding tanks (12V pads)  
 Electric patio awning with LED lights  
 Black holding tank sprayer  
 Sony® infotainment center with tilt/swivel, Apple® CarPlay and Android Auto™  
 Backup and side-view cameras  
 LED HD Smart TV in living area

## DRIVING

Ford® E-450 chassis  
 GVWR- 14,500 lb.  
 GCWR- 22,000 lb.  
 7.3L V-8 325 HP engine with 450 ft.-lb. torque  
 6-speed TorqShift® series transmission with overdrive  
 210-amp alternator  
 Catalytic converter theft deterrent  
 E-rated highway tires- LT225/75R16  
 Tire pressure monitoring system (TPMS)  
 Power anti-lock brakes with power steering  
 7,500 lb. hitch with 750 lb. tongue capacity and 7-pin plug  
 12V chassis battery  
 55 gal. fuel tank  
 Swivel driver and passenger seats (24B, 31F)  
 Remote-controlled, side-view mirrors  
 Tilt steering wheel  
 Cruise control  
 Hill start assist  
 Electronic stability control  
 Traction control  
 Auxiliary start switch  
 Power windows and door locks  
 Driver and passenger airbags  
 Privacy curtain for cab area

## EXTERIOR

StrongholdVBL™ roof, floor and sidewalls  
 Bead-foam insulation (R-24 max roof, R-9 max floor, R-5 max walls)  
 Tufflex™ PVC laminated roof  
 Aluminum running boards  
 Fiberglass exterior walls with vinyl graphics  
 Leveling jack prep  
 Frameless windows  
 Remote keyless cab entry  
 Entrance door with industry's largest travel-view window  
 Electric-powered entrance step with integrated house battery compartment  
 (2) high-output, marine-grade exterior speakers  
 Slideout awning(s)  
 Pass-through storage compartment with light (select models)  
 Third brake light  
 Roof ladder  
 Prep for satellite dish  
 Cable TV hookup with RG-6 coax  
 Digital antenna with signal booster

4,000W generator  
 Solar prep  
 12V house battery  
 Transfer switch with reverse polarity protection  
 30-amp electrical service  
 12.2 gal. propane tank (41 lb.)  
 LP quick-connect hookup  
 Exterior utility center  
 Winterization drain system  
 Outside shower  
 12V demand water pump  
 Water filtration system

## INTERIOR

Overhead bunk with 750 lb. capacity and safety net  
 84 in. ceiling height  
 High-intensity, recessed LED ceiling lights  
 LED-lit slideout fascia  
 Hardwood cabinet doors and drawer fronts  
 Ball-bearing drawer guides  
 Interior entrance door grab handle  
 Interior command center  
 Pleated blackout shades  
 15,000 BTU ducted A/C  
 30,000 BTU auto-ignition furnace  
 Electric fireplace (26M)  
 6 gal. gas/electric DSI auto-ignition water heater  
 Jayco-exclusive, easy-operation legless dinette table  
 2-point lap safety belts in all designated seating locations  
 JBL® audio system  
 10 cu. ft. 12V refrigerator  
 Furrion® all-in-one cooktop and oven  
 Residential-size microwave  
 Stainless steel kitchen sink  
 Decorative kitchen backsplash  
 Pop-up charging station with 120V outlet and USB plugs  
 LED-lit pressed countertops  
 Shower with decorative ABS surround and skylight  
 Stainless steel bathroom sink  
 Toilet with foot flush  
 Vent fan in bathroom  
 Queen-size bed with bedspread (24B, 29XK, 31F)  
 Queen-size power Murphy Bed (26M)  
 USB port and wireless charging in nightstands (29XK, 31F)  
 USB port in cabinet over bed (24B, 26M)  
 Under-bed storage (select models)  
 Large wardrobes  
 Bunks with industry-exclusive 300 lb. capacity each (31F)  
 Smoke alarm  
 Carbon monoxide detector  
 Fire extinguisher

## OPTIONS

Automatic hydraulic leveling jacks  
 Theater seating ILO dinette and additional TV in cab-over (24B, 26M)  
 Theater seating ILO sofa (29XK, 31F)  
 200W solar panel with dual controller and second house battery  
 Dual 13,500 BTU A/C units with power management system (26M, 29XK, 31F)  
 Folding windshield sun shade

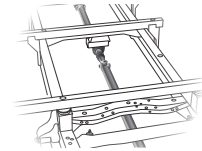

### COMPUTER-BALANCED DRIVESHAFT

Ensures smooth and efficient power transfer to the wheels

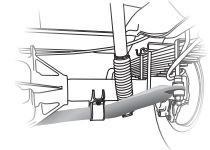

### STANDARD FRONT & REAR STABILIZER BARS

Reduces the body roll of a vehicle during fast cornering or over road irregularities

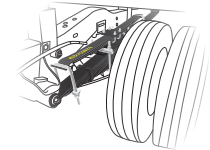

### HELLWIG® HELPER SPRINGS

Work with the chassis' existing springs to give the RV more support, improving stability under heavy loads

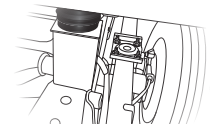

### RUBBER ISOLATION MOUNTS

Positioned near the tires to absorb road shock, dampen noise and minimize vibrations

FLOORPLAN	GVWR (lbs.)	GCWR (lbs.)	WHEEL BASE	OVERALL LENGTH	EXTERIOR HEIGHT WITH SATELLITE AND A/C	EXTERIOR WIDTH	INTERIOR HEIGHT	FRESH WATER CAPACITY (gal.)	GRAY WASTE WATER CAPACITY (gal.)	BLACK WASTE WATER CAPACITY (gal.)
24B	14,500	22,000	181"	26' 8"	11' 6"	100"	84"	43	40	31
26M	14,500	22,000	181"	28' 8"	11' 6"	100"	84"	44	41	32
29XK	14,500	22,000	223"	32' 6"	11' 6"	100"	84"	44	41	32
31F	14,500	22,000	223"	32' 6"	11' 6"	100"	84"	47	41	31

Meet your Jayco Dealer



Scan QR code for specification definitions

Some specs at the time of print may include estimates. For the most updated information, please visit [Jayco.com](http://Jayco.com)

Jayco Inc. | P.O. Box 460 | Middlebury, IN 46540

See dealer for further information and prices. All information in this brochure and on [www.jayco.com](http://www.jayco.com) is the latest available at the time of publication approval. Jayco reserves the right to make changes and to discontinue models without notice or obligation. Photography may show optional equipment or props used for decoration purposes only. RVs built for sale in Canada may differ to conform to Canadian codes. JAYCO and the JAYCO BIRD IN FLIGHT are registered trademarks of Jayco, Inc. Printed in USA 2/25 ©2025 Jayco, Inc. 2032954



Jayco - Part of Jayco Family of Companies