

Jayco | 2025 Eagle Fifth Wheel



EAGLE FW

ADVENTURES AROUND EVERY BEND

2+3
YEAR | YEAR
WARRANTY





CLASSIC FARMHOUSE



Main Wood



Accent Wood

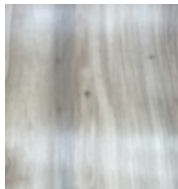

Floor

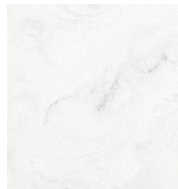

Countertop

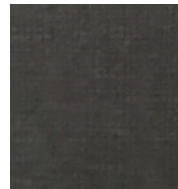

Main Fabric



Accent Fabric

317RLOK OPTIONS: A, B

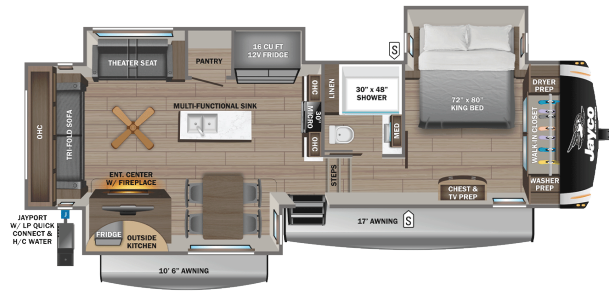

319MLOK OPTIONS: A, B, D

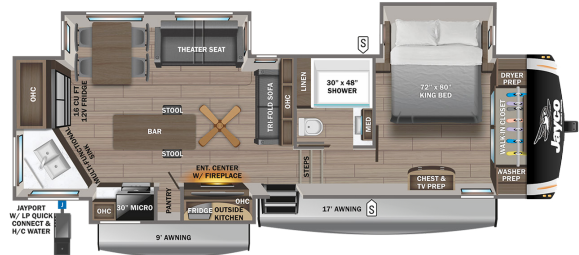

321RSTS OPTIONS: A, B, D, E

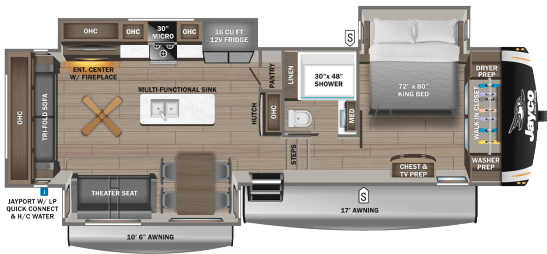

335RDOK OPTION: D

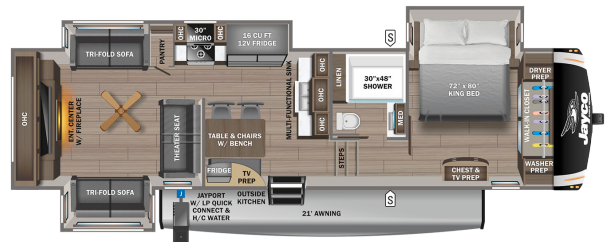

355MBOQ OPTIONS: A, B, C, D

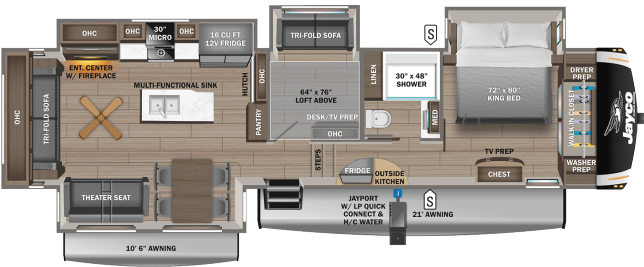

360DBOK OPTIONS: A, B, C, D

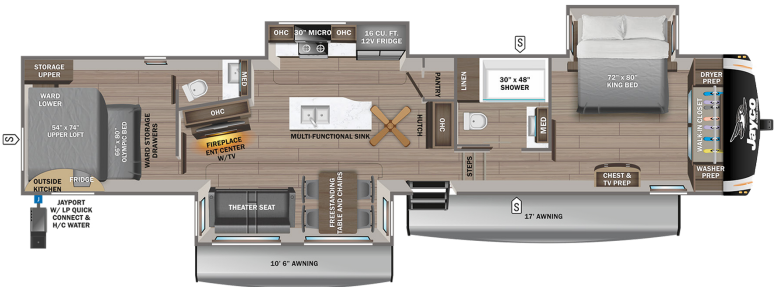

370FBTS OPTIONS: A, B, D, E

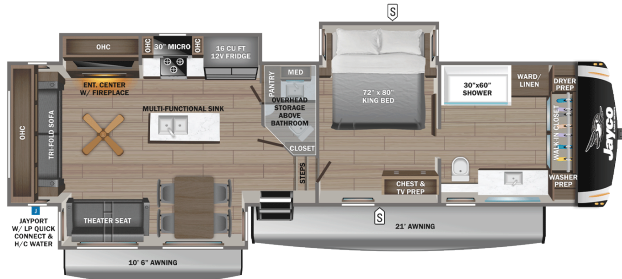

	STORAGE
	MICROWAVE
	OVERHEAD CABINETS
	REFRIGERATOR
	WARDROBE

OPTIONS

A	B	C	D	E
Table & Chairs/Bench	Dinette	Triple Recliner	Olympic Bed	Griddle/Sink

STANDARDS & OPTIONS

EXTERIOR

1.5 in. fresh water drain valve
 5 in. Magnum Truss™ with plywood roof decking
 50-amp detachable power cord
 Additional dump valve at termination
 Alpha Ply TPO roof membrane (thickest roof membrane with limited lifetime warranty)
 Auto-grade vinyl graphics
 Automotive style front cap with max turn radius
 Black tank flush
 Climate Shield™ zero-degree tested weather protection:
 * Fully enclosed and heated underbelly (ducted)
 * 35,000 BTU furnace
 * Double layer fiberglass batt insulation in ceiling and floor
 * Double sided radiant barrier insulation (roof, floor and behind cap)
 * PEX plumbing
 Commercial grade rubber flooring in pass through area
 Dual 30 lb. LP bottles
 Factory installed roof ladder
 Galvanneal steel coated outside kitchens
 HELIX Cooling System™ (industry exclusive):
 * Jayco exclusive insulated dual duct design
 * Directional and closeable A/C vents
 * Larger return air vents with user accessible filters
 Independent satellite and cable hookups (outside kitchens and/or pass through storage areas)
 LED exterior lighting package
 LED light and switch at termination
 LED lighting in pass through area
 LP quick connect for gas griddle (next to JayPort)
 Metal slam latch baggage doors
 Nautilus 2.5 water connections
 Nitrogen filled under mount spare tire (16 in.)
 Quick connect water connections (door side hot/cold and off door side cold only)
 Slide topper/awning prep
 Stronghold VBL™ walls (laminated sidewalls, rear walls and slide out walls)

INTERIOR

100% No Floor Vents
 2-piece high gloss bathroom surround
 5/8 in. tongue-and-groove plywood flooring
 75 lb. full extension drawer guides
 Bathroom skylight
 Bedroom TV, satellite and cable prep
 Extra 120V power outlets in kitchen and slide rooms (where applicable)
 Gas strutted under bed storage
 Handcrafted and glazed door/drawer fronts
 Matte black kitchen faucet with pull-out sprayer

Medicine cabinet with custom framed mirror
 NuVo H2O Water Treatment System (filters included)
 Porcelain foot flush toilet
 Residential vinyl flooring throughout (NO CARPET)
 Solid hardwood slide fascia
 Teak seat shower prep
 Theater seating (select models)
 Tri-fold hide-a-bed sofa with residential memory foam sleep surface (select models)
 USB 12V charging ports (multiple locations throughout)
 Water shutoff at all faucet locations

CUSTOMER VALUE PACKAGE (MANDATORY)

15,000 BTU "Whisper Quiet" A/C and bedroom A/C prep
 50-amp service with dual A/C ducts
 60,000 BTU on-demand tankless water heater
 Custom machined aluminum rims
 Electric patio awning (integrated dimmable LED lights with BMPro Tablet)
 Exterior "Blue Sync" Audio Connect with MB Quart Sound (TV and phone)
 Hidden hinges on cabinet doors
 Interior "Blue Sync" Audio Connect with MB Quart Sound (TV and phone)
 Keyed-Alike™ lock system
 MORryde Step Above™ entrance steps (main entrance) with blue LED light
 Rain proof bathroom power vent
 Rear 2 in. towing receiver with 4-pin connector
 Upgraded friction hinge entrance door
 Winegard Air 360 + antenna and router prep (NOW 5G)

LUXURY PACKAGE (MANDATORY)

Blackout roller shades with reflective side throughout
 Electric auto-leveling
 GE 30 in. over-the-range black and stainless microwave with exhaust fan
 Inverter pre-wire (multiple locations)((7) 110 outlets)(6 USBs 12V)
 JayPort 2 in. mount (for outside accessories)
 Magnetic catches for all drawers and doors
 Multi-Function "ALL in ONE" Stainless steel kitchen sink
 Residential style glass shower door
 Washer/dryer prep (select models)

5-STAR HANDLING PACKAGE (MANDATORY)

Dexter® ABS brake system with anti-sway
 Dexter® Axles with NEV-R-Adjust® brakes and E-Z Lube® hubs
 16 in. Goodyear® Endurance® tires (load range E)
 MORryde® CRE-3000™ rubberized suspension
 Wet bolt fasteners with bronze bushings

COMFORT PLUS PACKAGE (MANDATORY)

(317RLOK, 319MLOK, 321RSTS, 335RDOK, 355MBQS, 360DBOK, 370FBTS ONLY)
 15,000 BTU "Whisper Quiet" Bedroom A/C
 16 cu. ft. 12V refrigerator
 16 in. Endurance® Goodyear® wheels/tires
 50 in. 4K Ultra LED HD Smart TV in living room
 90 in. x 92 in. residential quilted bedspread
 BMPRO Bluetooth® light switches throughout
 Furniture cup holder tables (1 pair)
 GE 24 in. residential stove with 4-burner cooktop
 JAYCOMMAND® Smart RV System (Pro Tablet)
 JaySMART™ (Safety Marker And Reverse Travel) exterior LED lights
 King bed (72 in. x 80 in.) mattress with under-bed storage
 Larger exterior baggage door sizes
 LED fireplace with 5,000 BTU electric space heater
 LED lights with dimmer switches and motion activated (throughout interior)
 MORryde Safe-T-Rail grab handle
 Overlander 1 Solar Package (200W panel and 30-amp solar controller)
 Second power awning (dimmable LED lights)(select models)
 Security monitor prep (rear, sides and entrance door)
 Solid surface kitchen countertop
 TPMS in Stem Monitoring (Tire Pressure Monitoring System)

OPTIONS

360 degree security monitor kit with 7 in. view
 Booth dinette (select models)
 Dry camping package (generator prep)(Extra LP capacity)
 Extreme Weather Package with 120 heat pads & 12V heat tape on fresh water line
 Frameless dual pane windows
 Free standing table with leaf and 4 foldable Dinette chairs
 Free standing table with leaf and 4 foldable Dinette chairs in place of booth dinette
 HALO 22 in. outside griddle with deep sink attachment for JayPort system (select models)
 LED fireplace with 5,000 BTU electric space heater (select models)
 Overlander 2 Solar Package: (2) 200W panels, MPPT 30-amp solar controller and 1800W inverter)
 Overlander 4 Solar Package: (4) 200W panels, (2) 100AH lithium batteries, 60-amp MPPT solar controller, 3000 W split phase inverter/charger, DC/DC power converter, soft start 15,000 A/C with heat pump, battery monitor, roof pre-wire solar, generator option, battery enclosed)
 Residential 66 in. x 80 in. Olympic queen size mattress
 Triple reclining sofa ipo dinette (select models)

*Indicates split tanks

FLOORPLAN	TOTAL EXTERIOR LENGTH	EXTERIOR WIDTH	EXTERIOR HEIGHT (WITH A/C)	INTERIOR HEIGHT (MAIN)	INTERIOR HEIGHT (UPPER DECK)	UNLOADED VEHICLE WEIGHT	DRY HITCH WEIGHT	GVWR	CARGO CARRYING CAPACITY	FRESH WATER CAPACITY	GRAY WASTE WATER CAPACITY	BLACK WASTE WATER CAPACITY	SLEEPING CAPACITY
317RLOK	36' 7"	8' 1"	12' 11"	8' 7"	6' 6"	11,060	2,235	13,200	2,140	81	87*	50	2-4
319MLOK	36' 9"	8' 1"	12' 10"	8' 7"	6' 6"	11,030	2,255	13,300	2,270	81	87*	50	2-4
321RSTS	36' 7"	8' 1"	12' 10"	8' 8"	6' 7"	10,770	2,155	12,900	2,130	81	87*	TBD	TBD
335RDOK	37' 11"	8' 1"	12' 11"	8' 7"	6' 6"	11,120	2,185	13,300	2,180	81	50	50	4-6
355MBQS	42' 4"	8' 1"	12' 9"	8' 7"	6' 4"	12,985	2,515	15,400	2,415	81	50	50	6-8
360DBOK	43' 4"	8' 1"	13' 4"	8' 7"	6' 7"	12,660	2,615	14,950	2,290	81	87*	50	4-6
370FBTS	40' 10"	8' 1"	12' 10"	8' 7"	6' 6"	12,020	2,375	14,300	2,280	81	87*	87*	2-4

Meet your Jayco Dealer



Scan QR code for specification definitions

Some specs at the time of print may include estimates. For the most updated information, please visit Jayco.com

Jayco, Inc. | P.O. Box 460 | Middlebury, IN 46540

See dealer for further information and prices. All information in this brochure and on www.jayco.com is the latest available at the time of publication approval. Jayco reserves the right to make changes and to discontinue models without notice or obligation. Photography may show optional equipment or props used for decoration purposes only. RVs built for sale in Canada may differ to conform to Canadian codes. JAYCO and the JAYCO BIRD IN FLIGHT are registered trademarks of Jayco, Inc. Printed in USA 9/24 ©2024 Jayco, Inc. 2032975



Jayco - Part of Jayco Family of Companies