

**19MRK**

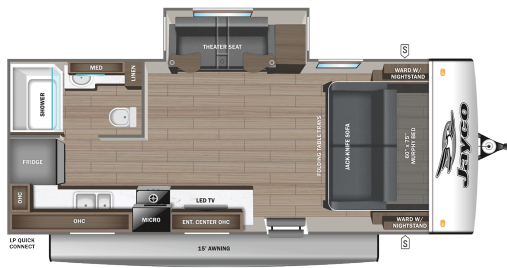

**21MBH** OPTION: B

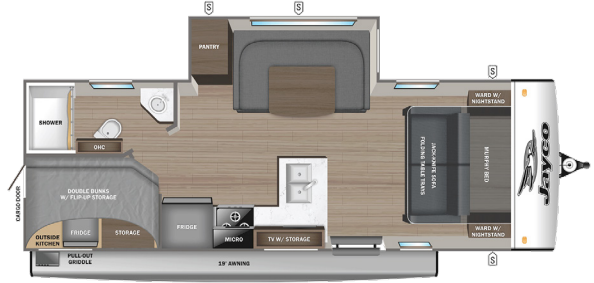

**21MML**

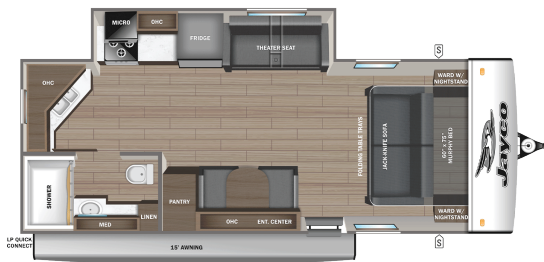

**22RB** OPTIONS: B, C

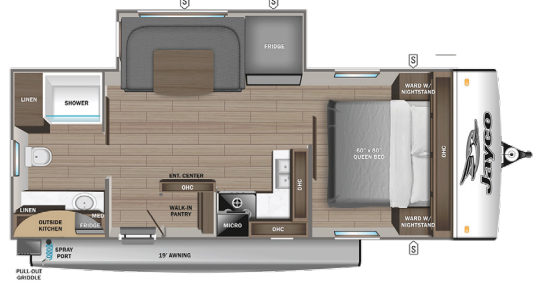

**23RK** OPTION: C



**24BH** OPTIONS: B, C

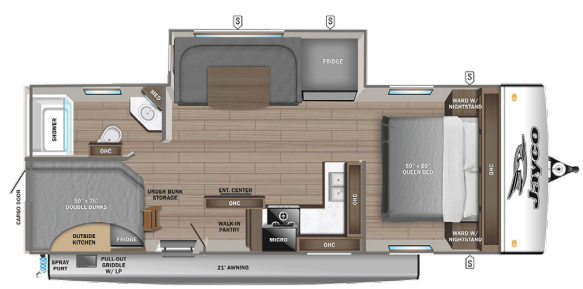

**24RL** OPTIONS: B, C



**25RB** OPTIONS: B, C, E



**OPTIONS**

- STORAGE
- MICRO** MICROWAVE
- OHC** OVERHEAD CABINETS
- FRIDGE** REFRIGERATOR
- WARD** WARDROBE

- A** Tri-fold Sofa
- B** Theater Seat
- C** King Bed
- D** Table & Chairs
- E** Mega Lounge

**26FK**    OPTIONS: C, D, E

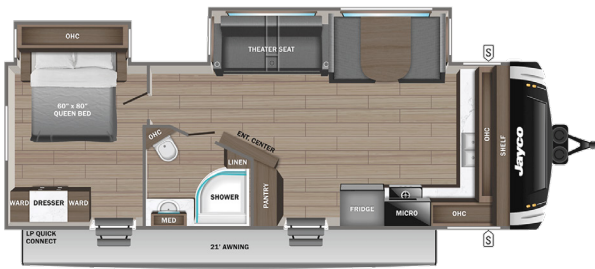

**26RL**    OPTIONS: C, D



**27BH**    OPTIONS: B, C, D, E



**27MK**    OPTIONS: B, C, D, E



**27RK**    OPTIONS: B, C, D, E

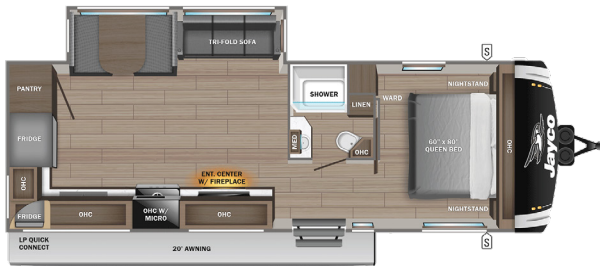

**28RB**    OPTIONS: B, C, D, E



**29HBH**    OPTIONS: B, C, D, E

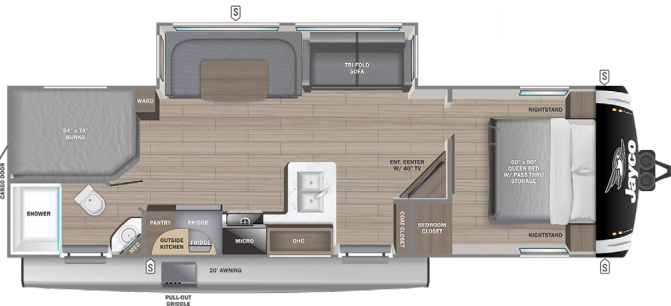

**29QBH**    OPTIONS: B, C, D, E

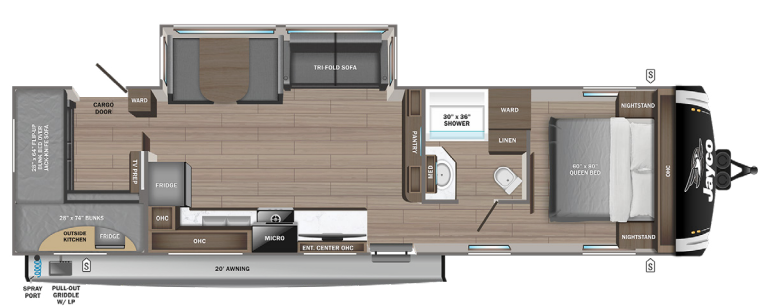

**OPTIONS**

- STORAGE
- MICRO**    MICROWAVE
- OHC**        OVERHEAD CABINETS
- FRIDGE**    REFRIGERATOR
- WARD**      WARDROBE

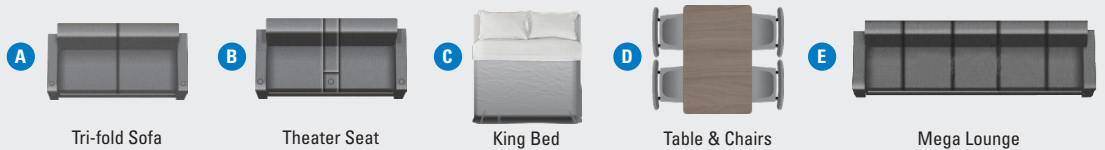

# JAY FEATHER



**29RL** OPTIONS: C, D, E

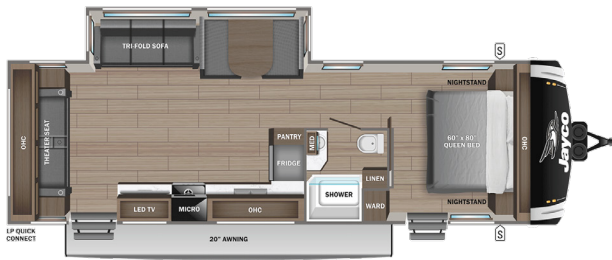

**31BH** OPTIONS: B, C, D, E



**32QBH** OPTIONS: B, C, D, E

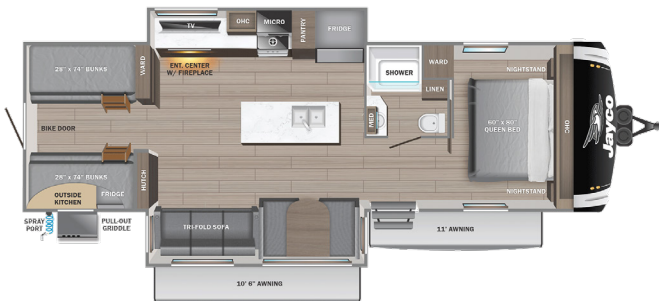

**32RL** OPTIONS: C, D, E



## OPTIONS

- STORAGE
- MICRO MICROWAVE
- OHC OVERHEAD CABINETS
- FRIDGE REFRIGERATOR
- WARD WARDROBE

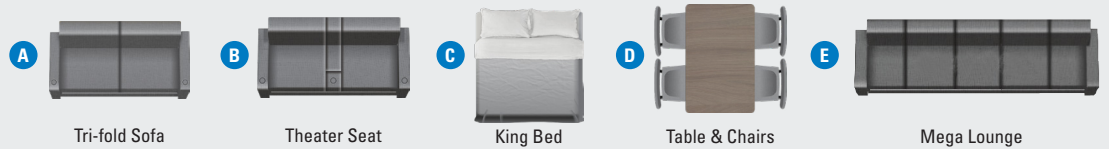

\*Indicates split tanks

FLOORPLAN	EXTERIOR TRAVEL LENGTH	EXTERIOR WIDTH	EXTERIOR HEIGHT (WITH A/C)	INTERIOR HEIGHT	UNLOADED VEHICLE WEIGHT	DRY HITCH WEIGHT	GVWR	CARGO CARRYING CAPACITY	FRESH WATER CAPACITY (INCLUDING WATER HEATER)	GRAY WASTE WATER CAPACITY	BLACK WASTE WATER CAPACITY	SLEEPING CAPACITY
19MRK	23' 2"	8' 0"	10' 8"	6' 6"	4,960	565	6,400	1,440	55	38	30.5	2
21MBH	26' 8"	8' 0"	10' 9"	6' 6"	5,545	615	6,995	1,450	55	30.5	30.5	6-8
21MML	25' 5"	8' 0"	10' 8"	6' 6"	5,225	975	6,500	1,275	55	30	30	2
22RB	27' 2"	8' 0"	10' 9"	6' 6"	5,590	635	7,000	1,410	55	60*	34	3-4
23RK	28' 7"	8' 0"	10' 8"	6' 6"	5,930	720	7,400	1,470	55	60*	30	3-4
24BH	29' 8"	8' 0"	10' 8"	6' 6"	6,080	720	7,500	1,420	55	61*	30.5	6-8
24RL	28' 0"	8' 0"	10' 9"	6' 6"	5,670	675	7,000	1,330	55	30	30	4-6
25RB	30' 1"	8' 0"	10' 8"	6' 6"	6,150	800	7,500	1,350	55	60*	34	2-4
26FK	31' 9"	8' 0"	11' 0"	6' 6"	7,065	925	8,500	1,435	54	60*	30	2
26RL	31' 4"	8' 0"	10' 8"	6' 6"	6,300	700	7,600	1,300	55	30	30	2-4
27BH	32' 3"	8' 0"	11' 0"	6' 6"	6,660	820	8,200	1,540	55	76*	38	8-10
27MK	33' 3"	8' 0"	10' 11"	6' 6"	7,305	800	8,850	1,545	55	71*	30.5	2-4
27RK	32' 4"	8' 0"	10' 11"	6' 6"	6,655	890	8,200	1,545	55	60*	30	4-6
28RB	33' 1"	8' 0"	10' 11"	6' 6"	6,770	815	8,400	1,630	55	60*	30	4-6
29BHB	34' 0"	8' 0"	10' 10"	6' 6"	7,000	715	8,500	1,500	55	68.5*	30.5	8-10
29QBH	35' 7"	8' 0"	10' 10"	6' 6"	7,330	958	8,850	1,520	55	61*	30.5	4-7
29RL	35' 4"	8' 0"	11' 0"	6' 6"	7,130	950	8,650	1,520	54	60*	40	4-6
31BH	37' 2"	8' 0"	11' 0"	6' 6"	8,010	1,085	9,600	1,590	55	70*	60*	5-7
32QBH	37' 8"	8' 0"	11' 0"	6' 6"	8,000	1,035	9,600	1,600	55	57	30.5	6-8
32RL	35' 7"	8' 0"	11' 0"	6' 6"	7,580	980	9,000	1,420	55	71*	30.5	2-4

Some specs at the time of print may include estimates. For the most updated information, please visit Jayco.com

# STANDARDS & OPTIONS

## EXTERIOR

1.5 in. fresh water drain valve  
18 in. rear roof ladder - factory installed  
2 in. Stronghold VBL™ floor with 2 lb. density foam  
Stronghold VBL™ walls with double-sided Azdel composite (sidewalls, rear walls and slide out boxes)  
Aerodynamic, rounded front profile with aluminum framing  
American-made Norco Z-frame with integrated A-frame  
Automotive-style aluminum rims  
Battery quick-disconnect  
Dark-tinted safety-glass windows  
Front diamond plating  
Front molded decorative cap  
Galvanized steel and impact resistant wheel wells  
Keyed-Alike™ locking system  
Magnum Truss™ Roof System  
Marine grade exterior speakers  
Outdoor camp kitchen with galvanized steel bases (select models)  
PVC roofing membrane (limited lifetime warranty)  
Swing-out entry door assist handle  
Exterior TV Hookups 120V and cable

## INTERIOR

4 in. high-density dinette cushions with vinyl backing  
4 in. soft-touch bunk mats (select models)  
60 x 80 in. residential queen beds (60 x 76 in. in Murphy bed models)  
75 lb. full extension drawer guides  
Bathroom skylight  
Decorative backsplash  
Decorative roller shades with reflective barrier  
Directional and closeable A/C vents  
Gas-strutted under bed storage (most models)  
Handcrafted, hardwood door/drawer fronts  
Hidden-hinged cabinet doors  
High output auto-ignition LP gas furnace

LED lighting throughout  
Plywood dinette, bed, bunk and shower/tub bases  
Powered roof vents in bathroom and main bedroom (most models)  
Residential style seamless countertops throughout  
Residential vinyl flooring throughout  
Screwed and glued cabinet stiles  
USB charging ports (multiple locations throughout)

## CUSTOMER VALUE PACKAGE (MANDATORY)

Radial tires with self-adjusting electric brakes  
13,500 BTU Mach Quiet Series A/C  
20 lb. LP gas bottles with auto-regulator and ABS cover  
55 gal. fresh water tank  
Automotive-style aluminum rims  
Black tank flush  
Detachable power cord  
Inverter pre-wire (2 bedroom nightstand outlets, main TV and outlet for outside kitchen fridge)  
Max-length power awning with LED light  
On-demand 60,000 BTU water heater  
Power tongue jack  
Rock Solid Stabilizer System  
Side and rear back-up camera prep  
Under-mount spare tire

## JAY SPORT PACKAGE (MANDATORY)

11 cu. ft. 12V fridge  
Tire Pressure Monitoring (App based)  
Climate Shield (zero to 100 degree tested weather insulation package)  
Front slam-latch baggage doors  
Invision appliance package  
LCI Solid Step fold-down aluminum tread steps on main entry door  
LED smart TV  
MAXXAIR® power roof vent (main living area)

Modern graphics package with dual-colored sidewall  
Overlander 1 Solar Package: (1) 200W solar panel and 30-amp digital controller  
Porcelain foot-flush toilet  
Stainless steel kitchen & bathroom sink

## OPTIONS

120V heated tank pads  
15,000 BTU Mach Quiet Series A/C  
2nd A/C (select models)  
Front molded decorative cap  
Rear 2 in. receiver  
30 lb. LP gas bottles with auto-regulator  
50-amp service (N/A on 19MRK, 21MML, 21MBH)  
72 x 80 in. King bed (select models)  
Electric fireplace (N/A 21MBH, 21MML, 23RK) (Standard on 26FK, 27MK, 27RK, 31BH, 32QBH, 32RL)  
Freestanding table and 4 chairs (select models)  
JAYCOMMAND® Smart RV System (select models)  
Mega-lounger - Theater seating with tri-fold sofa and party trays (select models)  
Overlander 2 Solar Package: (2) 200W solar panels, 30-amp digital controller and 1,800W inverter

Meet your Jayco Dealer



Scan QR code for specification definitions

Some specs at the time of print may include estimates. For the most updated information, please visit [Jayco.com](https://www.jayco.com)

Jayco, Inc. | P.O. Box 460 | Middlebury, IN 46540

See dealer for further information and prices. All information in this brochure and on [www.jayco.com](https://www.jayco.com) is the latest available at the time of publication approval. Jayco reserves the right to make changes and to discontinue models without notice or obligation. Photography may show optional equipment or props used for decoration purposes only. RVs built for sale in Canada may differ to conform to Canadian codes. JAYCO and the JAYCO BIRD IN FLIGHT are registered trademarks of Jayco, Inc. Printed in USA 11/24 ©2024 Jayco, Inc. 2032967



Jayco - Part of Jayco Family of Companies