

JAY FLIGHT SLX

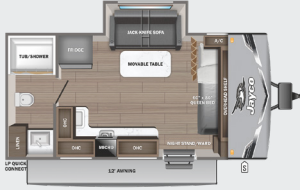

SINGLE AXLE

160LK/W



170BH/W **SPORT**



170FQ/W **SPORT**



175BH/W



175FQ/W



197MB/W



DOUBLE AXLE

200MKS/W

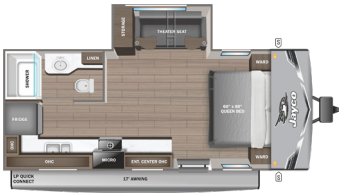

210QB/W



211MB/W



225MLS/W



235MBH/W

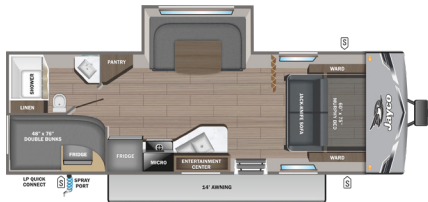

236TH/W

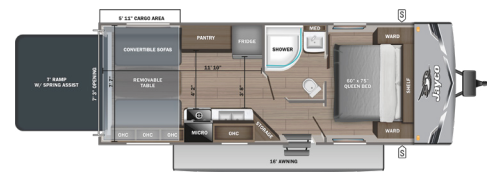

240RBS/W



255THW



260BH/W



JAY FLIGHT SLX



261BHS/W

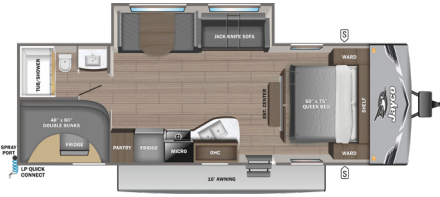

262RLS/W



263BHS/W



263RBS



265BHS/W



265TH/W

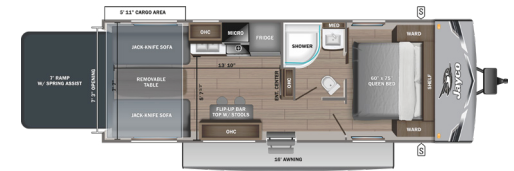

280FKS

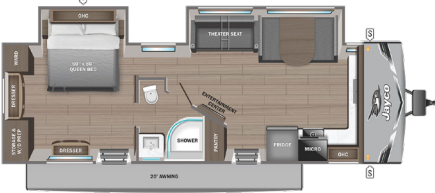

284BHS

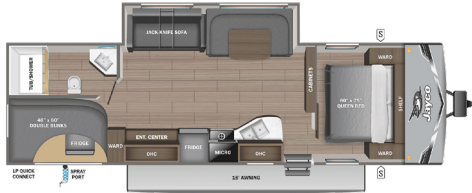

286BHSW



287BHS/W



290RKS

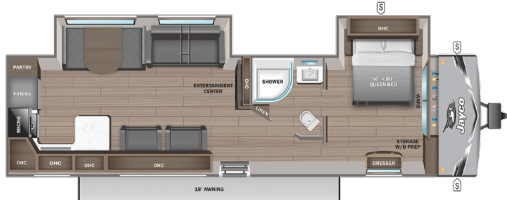

294QBS

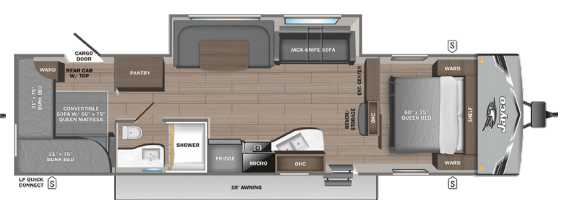

321BDS

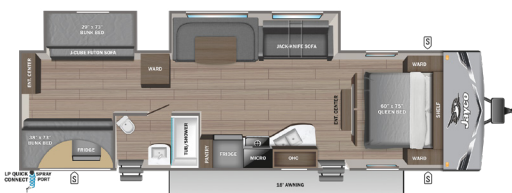

330TBS



333BTS



JAY FLIGHT SLX



334RTS

380DS

/W WEST MODEL

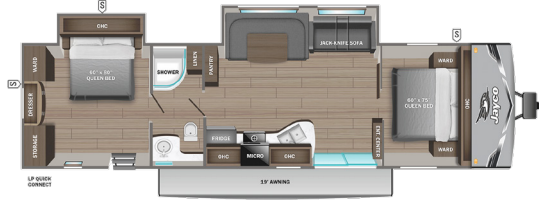
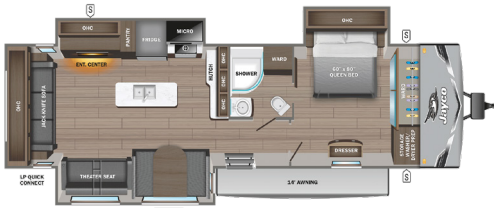

S STORAGE
MICRO MICROWAVE
OHC OVERHEAD CABINETS
FRIDGE REFRIGERATOR
WARD WARDROBE

*Indicates split tanks

FLOORPLAN	TOTAL EXTERIOR LENGTH	EXTERIOR WIDTH	EXTERIOR HEIGHT (WITH A/C)	INTERIOR HEIGHT	UNLOADED VEHICLE WEIGHT	DRY HITCH WEIGHT	GVWR	CARGO CARRYING CAPACITY	FRESH WATER CAPACITY	GRAY WASTE WATER CAPACITY	BLACK WASTE WATER CAPACITY	SLEEPING CAPACITY
160LK	21' 5"	8' 0"	10' 3"	6' 6"	3,545	325	4,750	1,205	30	20	20	2-4
160LKW	21' 7"	8' 0"	10' 2"	6' 6"	3,540	355	4,750	1,210	30	20	20	2-4
170BH	21' 3"	8' 0"	10' 3"	6' 6"	3,000	315	3,750	750	30	20	20	3-5
170BHW	TBD	8' 0"	TBD	6' 6"	TBD	TBD	TBD	TBD	TBD	TBD	TBD	3-5
170FQ	TBD	8' 0"	TBD	6' 6"	TBD	TBD	TBD	TBD	TBD	TBD	TBD	2-3
170FQW	TBD	8' 0"	TBD	6' 6"	TBD	TBD	TBD	TBD	TBD	TBD	TBD	2-3
175BH	22' 1"	8' 0"	10' 3"	6' 6"	3,215	305	4,500	1,285	30	20	20	3-5
175BHW	22' 1"	8' 0"	10' 3"	6' 6"	3,150	305	4,600	1,450	30	20	20	3-5
175FQ	21' 11"	8' 0"	10' 6"	6' 6"	3,295	304	4,500	1,205	30	20	20	2-3
175FQW	21' 11"	8' 0"	10' 2"	6' 6"	3,160	320	4,500	1,340	30	20	20	2-3
197MB	23' 5"	8' 0"	10' 3"	6' 6"	3,990	585	5,150	1,160	30	39	39	6-8
197MBW	23' 7"	8' 0"	10' 3"	6' 6"	3,785	585	5,140	1,355	30	40	40	6-8
200MKS	34' 4"	8' 0"	11' 1"	6' 6"	4,790	525	7,900	1,705	52	39	39	1-2
200MKSW	TBD	8' 0"	TBD	6' 6"	TBD	TBD	TBD	TBD	TBD	TBD	TBD	1-2
210QB	25' 10"	8' 0"	10' 7"	6' 6"	4,255	520	6,000	1,745	52	39	39	3-5
210QBW	25' 8"	8' 0"	10' 6"	6' 6"	4,190	470	6,000	1,810	84	40	40	3-5
211MB	24' 6"	8' 0"	10' 6"	6' 6"	6,170	750	3,500	1,430	84	40	40	5-7
211MBW	24' 6"	8' 0"	10' 6"	6' 6"	4,120	510	6,000	1,880	84	40	40	5-7
225MLS	TBD	8' 0"	TBD	6' 6"	TBD	TBD	TBD	TBD	TBD	TBD	TBD	2-3
225MLSW	TBD	8' 0"	TBD	6' 6"	TBD	TBD	TBD	TBD	TBD	TBD	TBD	2-3
235MBH	TBD	8' 0"	TBD	6' 6"	TBD	TBD	TBD	TBD	TBD	TBD	TBD	5-7
235MBHW	TBD	8' 0"	TBD	6' 6"	TBD	TBD	TBD	TBD	TBD	TBD	TBD	5-7
236TH	TBD	8' 0"	TBD	6' 6"	TBD	TBD	TBD	TBD	TBD	TBD	TBD	4-6
236THW	TBD	8' 0"	TBD	6' 6"	TBD	TBD	TBD	TBD	TBD	TBD	TBD	4-6
240RBS	TBD	8' 0"	TBD	6' 6"	TBD	TBD	TBD	TBD	TBD	TBD	TBD	1-2
240RBSW	TBD	8' 0"	TBD	6' 6"	TBD	TBD	TBD	TBD	TBD	TBD	TBD	1-2
255THW	TBD	8' 0"	TBD	6' 6"	TBD	TBD	TBD	TBD	TBD	TBD	TBD	2-4
260BH	29' 5"	8' 0"	10' 5"	6' 9"	4,600	505	6,500	1,900	84	40	40	7-9
260BHW	29' 5"	8' 0"	10' 5"	6' 9"	4,600	505	6,500	1,900	84	40	40	7-9
261BHS	30' 4"	8' 0"	12' 0"	6' 9"	5,750	710	7,500	1,750	52	39	39	7-9
261BHSW	TBD	8' 0"	TBD	6' 9"	TBD	TBD	TBD	TBD	TBD	TBD	TBD	7-9
262RLS	32' 0"	8' 0"	11' 1"	6' 9"	6,080	790	7,600	1,520	52	39	39	3-5
262RLSW	31' 1"	8' 0"	10' 7"	6' 9"	6,035	760	7,600	1,565	80	40	40	3-5
263BHS	32' 7"	8' 0"	11' 1"	6' 9"	6,170	750	7,600	1,430	30	71.25*	39	7-9
263BHSW	TBD	8' 0"	TBD	TBD	TBD	TBD	TBD	TBD	TBD	TBD	TBD	7-9
263RBS	TBD	8' 0"	TBD	TBD	TBD	TBD	TBD	TBD	TBD	TBD	TBD	2-3
265BHS	30' 10"	8' 0"	11' 1"	6' 9"	5,955	635	7,600	1,645	52	78*	39	7-9
265BHSW	30' 10"	8' 0"	11' 0"	6' 9"	5,875	600	7,600	1,725	76	80*	40	7-9
265TH	TBD	8' 0"	TBD	TBD	TBD	TBD	TBD	TBD	TBD	TBD	TBD	4-6
265THW	TBD	8' 0"	TBD	TBD	TBD	TBD	TBD	TBD	TBD	TBD	TBD	4-6
280FKS	TBD	8' 0"	TBD	TBD	TBD	TBD	TBD	TBD	TBD	TBD	TBD	2-3

Some specs at the time of print may include estimates. For the most updated information, please visit Jayco.com

STANDARDS & OPTIONS

FLOORPLAN	TOTAL EXTERIOR LENGTH	EXTERIOR WIDTH	EXTERIOR HEIGHT (WITH A/C)	INTERIOR HEIGHT	UNLOADED VEHICLE WEIGHT	DRY HITCH WEIGHT	GVWR	CARGO CARRYING CAPACITY	FRESH WATER CAPACITY	GRAY WASTE WATER CAPACITY	BLACK WASTE WATER CAPACITY	SLEEPING CAPACITY
284BHS	TBD	8' 0"	TBD	TBD	TBD	TBD	TBD	TBD	TBD	TBD	TBD	7-9
286BHSW	TBD	8' 0"	TBD	TBD	TBD	TBD	TBD	TBD	TBD	TBD	TBD	7-8
287BHS	34' 4"	8' 0"	11' 1"	6' 9"	6,195	755	7,900	1,705	52	39	39	7-9
287BHSW	TBD	8' 0"	TBD	TBD	TBD	TBD	TBD	TBD	TBD	TBD	TBD	7-9
290RKS	TBD	8' 0"	TBD	TBD	TBD	TBD	TBD	TBD	TBD	TBD	TBD	7-9
294QBS	TBD	8' 0"	TBD	TBD	TBD	TBD	TBD	TBD	TBD	TBD	TBD	7-9
321BDS	36' 4"	8' 0"	11' 4"	6' 9"	7,600	1,070	9,300	1,700	52	39	39	7-9
330TBS	TBD	8' 0"	TBD	TBD	TBD	TBD	TBD	TBD	TBD	TBD	TBD	5-7
333BTS	37' 10"	8' 0"	11' 4"	6' 9"	8,370	1,205	10,500	2,130	52	71.5*	39	8-10
334RTS	TBD	8' 0"	TBD	TBD	TBD	TBD	TBD	TBD	TBD	TBD	TBD	2-4
380DQS	TBD	8' 0"	TBD	TBD	TBD	TBD	TBD	TBD	TBD	TBD	TBD	5-7

EXTERIOR

30-amp service
8,000 BTU wall mount A/C (single axle models)
Axles with electric, self-adjusting brakes and easy-lube hubs
Exterior cable TV hookup
Fully-integrated A-frame
Galvanized-steel, impact resistant wheel wells
Large exterior downspouts
*LP quick connect (outside grill prep)
Magnum Truss™ Roof System
Nitrogen filled radial tires
PVC roofing membrane (limited lifetime warranty)

INTERIOR

300 lb. rated single bunk beds
600 lb. rated double bunk beds
Digital TV antenna
Heavy-duty, 75 lb., full-extension, steel ball-bearing drawer guides
High rise kitchen faucet
Marine-grade toilet with foot flush
Plywood bed platforms
Queen mattress
Residential-style hidden cabinet door hinges
Residential-style kitchen countertops
Shower curtain with curved shower track (select models)
Solid hardwood cabinet doors with screwed stile construction and hidden hinges
Vinyl flooring throughout
*Wood-trimmed mirror in bathroom

CUSTOMER VALUE PACKAGE (MANDATORY)

8 cu. ft. 12V refrigerator
AM/FM/Bluetooth® stereo
Backup camera prep
Bathroom skylight
Bathroom vent
Detachable power cord
Entry door with window and shade prep

Fitted bed sheet
G20 dark tinted privacy windows
Keyed-Alike™ entry and baggage doors
Large folding entry door grab handle
LED interior and exterior lights
Marine grade exterior stereo speakers
Microwave oven
On-demand tankless water heater
Power awning with LED lights
Range hood
Solid Step® entry steps
Spare tire with cover
Stabilizer jacks
Tub/shower surround
Window shades

CUSTOMER VALUE PACKAGE - SPORT EDITION

3.3 Cu Ft 12V Refrigerator
19k BTU Furnace
2 Burner Stove Top
Bathroom Vent
Detachable Power Cord
Entry Door w/Window and Shade Prep
G20 Dark Tinted Privacy Windows
LED Interior and Exterior Lights
Microwave Oven
Stabilizer Jacks
Window Shades
Power Awning
Front Tongue Jack
Rear Bumper, 20# LP bottle
On-demand Tankless Water Heater

STX EDITION (INDIANA BUILT UNITS ONLY)

16 in. off-road tires
30 lb. LP bottle
Deluxe graphics package
Triple entry step
Enclosed underbelly
Oversized wheel fenders

Power tongue jack
Stabilizer jacks (4)

BAJA PACKAGE (IDAHO BUILT UNITS ONLY)

16 in. off-road tires
30 lb. LP bottle
Deluxe graphics package
Triple entry step
Enclosed underbelly
Oversized wheel fenders
Stabilizer jacks (4)

OPTIONS

King bed (select models)
Table and chairs (select models)
13,500 BTU roof mounted A/C (standard on double axle units)
*15,000 BTU roof mounted A/C (select models)
*Baja Package (Idaho single axle units only)
*Fiberglass sidewalls
*Outside griddle with LP quick connect hose
*Overlander 1 Solar Package: (1) 200W solar panel and 30-amp digital controller
*STX Edition (Indiana built, single axle units only)

ELITE PACKAGE

Fiberglass walls
Aluminum rims (on Ranier tires)
Fireplace (N/A on 235MBH, 225MLS, 265BHS)
Medicine cabinet
Window in slideroom
Enclosed underbelly
Enhanced graphics
Pull out kitchen faucet
N/A on non-slideout models
N/A Single Axles

*N/A with Sport Edition

Meet your Jayco Dealer



Scan QR code for specification definitions

Some specs at the time of print may include estimates. For the most updated information, please visit Jayco.com

Jayco, Inc. | P.O. Box 460 | Middlebury, IN 46540

See dealer for further information and prices. All information in this brochure and on www.jayco.com is the latest available at the time of publication approval. Jayco reserves the right to make changes and to discontinue models without notice or obligation. Photography may show optional equipment or props used for decoration purposes only. RVs built for sale in Canada may differ to conform to Canadian codes. JAYCO and the JAYCO BIRD IN FLIGHT are registered trademarks of Jayco, Inc. Printed in USA 11/24 ©2024 Jayco, Inc. 2032969



Jayco - Part of Jayco Family of Companies