

# EAGLE HT TT

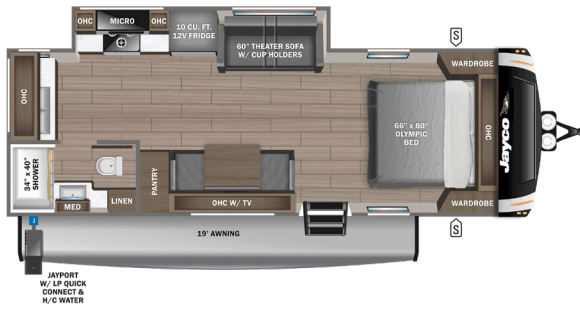

**230MLCS** OPTION: F



**274FKDS** OPTIONS: B, E, F

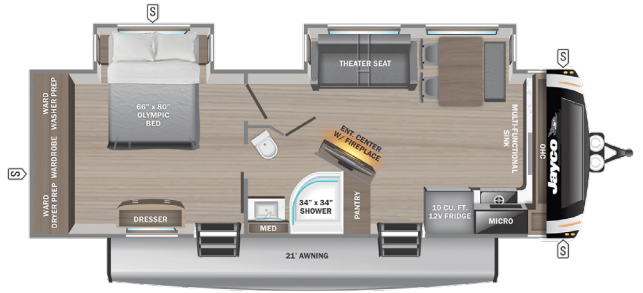

**284BHOK** OPTIONS: A, C, D

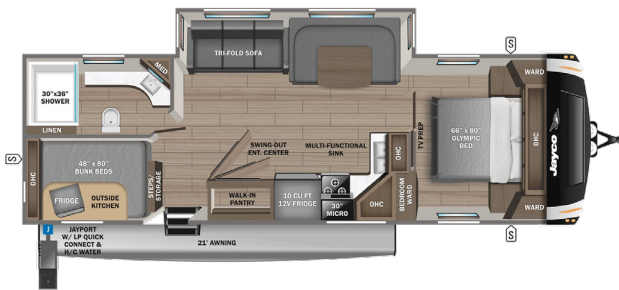

**294CKBS** OPTIONS: B, E, F

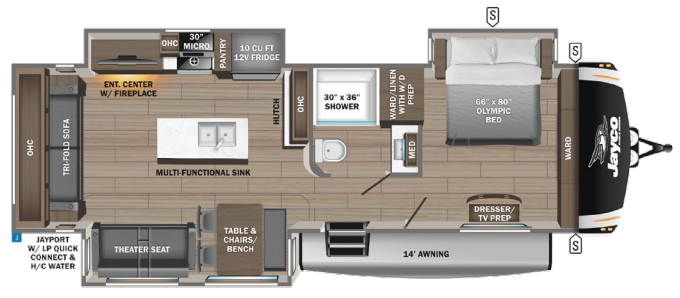

**295RUCD**

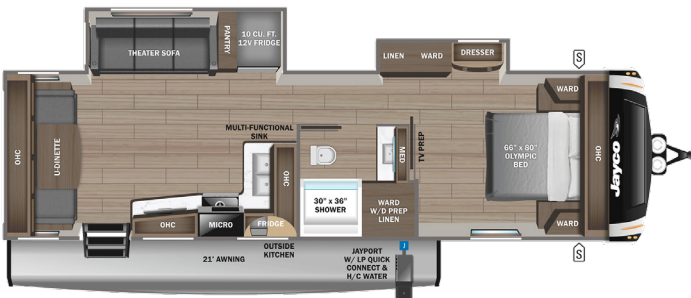

**312BHOK** OPTIONS: A, C, D

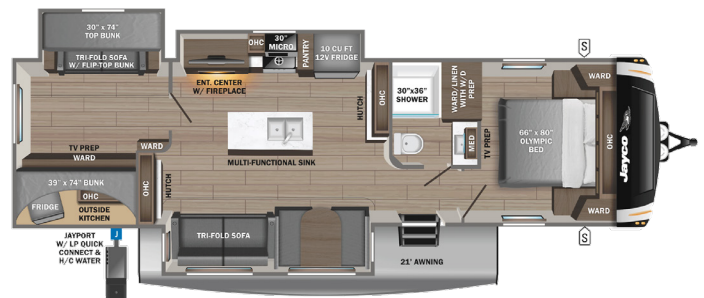

**320MKTS** OPTIONS: C, E, F

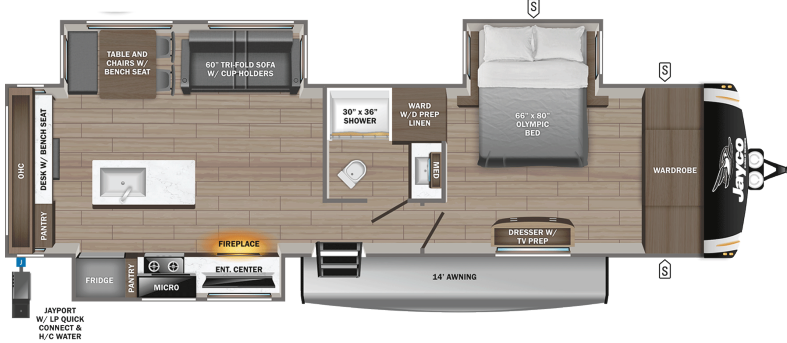

**S** STORAGE  
**MICRO** MICROWAVE  
**OHC** OVERHEAD CABINETS  
**FRIDGE** REFRIGERATOR  
**WARD** WARDROBE

**OPTIONS**

**A** Table & Chairs/Bench  
**B** Dinette  
**C** Triple Recliner  
**D** Theater Seat  
**E** King Bed  
**F** Jayport

# STANDARDS & OPTIONS

## EXTERIOR

1.5 in. fresh water drain valve  
 5 in. Magnum Truss™ with plywood roof decking  
 50-amp detachable power cord  
 Additional dump valve at termination  
 Alpha Ply TPO roof membrane (thickest roof membrane with limited lifetime warranty)  
 Auto-grade vinyl graphics  
 Automotive style front cap with max turn radius  
 Backup camera prep  
 Black tank flush  
 Climate Shield™ zero-degree tested weather protection:  
 \* Fully enclosed and heated underbelly (ducted)  
 \* 35,000 BTU furnace  
 \* Double layer fiberglass batt insulation in ceiling and floor  
 \* Double sided radiant barrier insulation (roof, floor and behind cap)  
 \* PEX plumbing  
 Dual 30 lb. LP bottles  
 Factory installed roof ladder  
 Galvanneal steel coated outside kitchens  
 HELIX Cooling System™ (industry exclusive):  
 \* Jayco exclusive insulated dual duct design  
 \* Directional and closeable A/C vents  
 \* Larger return air vents with user accessible filters  
 Independent satellite and cable hookups (outside kitchens and/or pass through storage areas)  
 LED exterior lighting package  
 LED light and switch at termination  
 LED lighting in pass through area  
 LP quick connect for gas griddle (next to JayPort)  
 Metal slam latch baggage doors  
 Nautilus 2.5 water connections  
 Nitrogen filled under mount spare tire (model/option varies 15 in. or 16 in.)  
 Overlander solar prep (roof)  
 Quick connect water connections (door side hot/cold and off door side cold only)  
 Slide topper/awning prep  
 Stronghold VBL™ walls (laminated sidewalls, rear walls and slide out walls)

## INTERIOR

100% No Floor Vents

2-piece high gloss bathroom surround  
 5/8 in. tongue-and-groove plywood flooring  
 75 lb. full extension drawer guides  
 Bathroom skylight  
 Bedroom TV, satellite and cable prep  
 CPAP prepped bedroom (both sides)  
 Extra 120V power outlets in kitchen and slide rooms (where applicable)  
 Gas strutted under bed storage  
 Handcrafted and glazed door/drawer fronts  
 LED fireplace with 5,000 BTU electric space heater (select models)  
 Matte black kitchen faucet with pull-out sprayer  
 Medicine cabinet with custom framed mirror  
 NuVo H2O Water Treatment System (filters included)  
 Porcelain foot flush toilet  
 Residential vinyl flooring throughout (NO CARPET)  
 Solid hardwood slide fascia  
 Teak Seat Shower Prep  
 Theater seating (select models)  
 Tri-fold hide-a-bed sofa with residential memory foam sleep surface (select models)  
 USB 12V charging ports (multiple locations throughout)  
 Water shutoff at all faucet locations

## CUSTOMER VALUE PACKAGE (MANDATORY)

15,000 BTU "Whisper Quiet" A/C and bedroom A/C prep  
 40 in. 4K Ultra LED HD Smart TV in living room  
 50-amp service with dual A/C ducts  
 60,000 BTU on-demand tankless water heater  
 Custom machined aluminum rims  
 Electric patio awning  
 Exterior "Blue Sync" Audio Connect with MB Quart Sound (TV and phone)  
 Hidden hinges on cabinet doors  
 Interior "Blue Sync" Audio Connect with MB Quart Sound (TV and phone)  
 Keyed-Alike™ lock system  
 MORryde Step Above™ entrance steps (main entrance) with blue LED light  
 Rain proof bathroom power vent  
 Rear 2 in. towing receiver  
 Upgraded friction hinge entrance door

Winegard Air 360 + antenna and router prep (NOW 5G)

## LUXURY PACKAGE (MANDATORY)

Blackout roller shades with reflective side throughout  
 GE 10 cu. ft. 12V refrigerator  
 GE 30 in. over-the-range black and stainless microwave with exhaust fan  
 GE black and stainless 21 in. range with edge to edge grates  
 Inverter pre-wire (multiple locations)((7) 110 outlets)(6 USBs 12V)  
 JayPort 2 in. mount (for outside accessories)  
 Magnetic Catches for all drawers and doors  
 Multi-Function "ALL in ONE" Stainless steel kitchen sink  
 Residential 66 in. x 80 in. OLYMPIC size mattress  
 Residential style glass shower door  
 Washer/dryer prep (select models)

## 4-STAR HANDLING PACKAGE (MANDATORY)

Dexter® Axles with NEV-R-Adjust® brakes and E-Z Lube® hubs  
 Goodyear® Endurance® tires (load range E)  
 MORryde® CRE-3000™ rubberized suspension  
 Wet bolt fasteners with bronze bushings

## OPTIONS

15,000 BTU bedroom A/C  
 Booth dinette (select models)  
 Dexter® ABS brake system with anti-sway  
 Electric auto-leveling with JAYCOMMAND® Smart RV system  
 Extreme Weather Package with 120 heat pads and 12V heat tape on fresh water line  
 Frameless dual pane windows  
 Free standing table with leaf and bench seat and 2 foldable dinette chairs  
 Furniture cup holder tables (1 pair)  
 HALO 22 in. outside griddle with deep sink attachment for JayPort system (select models)  
 JAYCOMMAND® Smart RV System with TPMS monitoring  
 King bed (72 in. x 80 in.) mattress with under-bed storage  
 LED fireplace with 5,000 BTU electric space heater (select models)  
 Overlander 1 Solar Package (200W panel and 30-amp solar controller)  
 Overlander 2 Solar Package: (2) 200W panels, MPPT 30-amp solar controller and 1800W inverter)  
 Residential 72 in. x 80 in. king size mattress (select models)  
 Theater seating in place of tri-fold sofa (select models)  
 Triple reclining sofa ipo dinette (select models)

\*Indicates split tanks

FLOORPLAN	TOTAL EXTERIOR LENGTH	EXTERIOR WIDTH	EXTERIOR HEIGHT (WITH A/C)	INTERIOR HEIGHT	UNLOADED VEHICLE WEIGHT	DRY HITCH WEIGHT	GVWR	CARGO CARRYING CAPACITY	FRESH WATER CAPACITY	GRAY WASTE WATER CAPACITY	BLACK WASTE WATER CAPACITY	SLEEPING CAPACITY
230MLCS	27' 8"	8' 1"	11' 9"	7' 0"	6,575	795	8,400	1,825	52	74*	37	2
274FKDS	34' 10"	8' 1"	11' 8"	7' 0"	8,545	1,095	10,600	2,055	52	111*	37	2
284BHOK	34' 10"	8' 1"	11' 7"	7' 0"	7,960	1,500	9,995	2,035	81	74*	37	8-10
294CKBS	38' 0"	8' 1"	11' 10"	7' 0"	9,470	1,280	11,700	2,230	52	74*	37	2-4
295RUCD	33' 10"	8' 1"	11' 8"	7' 0"	8,200	1,000	10,250	2,050	52	74*	37	4-6
312BHOK	38' 8"	8' 1"	11' 11"	7' 0"	9,795	1,330	11,500	1,705	52	74*	38	9-11
320MKTS	36' 8"	8' 1"	12' 0"	7' 0"	9,175	1,145	11,500	2,325	52	74*	37	2-4

Meet your Jayco Dealer



Scan QR code for specification definitions

Some specs at the time of print may include estimates. For the most updated information, please visit [Jayco.com](http://Jayco.com)

Jayco, Inc. | P.O. Box 460 | Middlebury, IN 46540

See dealer for further information and prices. All information in this brochure and on [www.jayco.com](http://www.jayco.com) is the latest available at the time of publication approval. Jayco reserves the right to make changes and to discontinue models without notice or obligation. Photography may show optional equipment or props used for decoration purposes only. RVs built for sale in Canada may differ to conform to Canadian codes. JAYCO and the JAYCO BIRD IN FLIGHT are registered trademarks of Jayco, Inc. Printed in USA 10/24 ©2024 Jayco, Inc. 2032973



Jayco - Part of Jayco Family of Companies