

Jayco | 2025 Alante SE Class A Motorhome



ALANTE SE

COMFORT MEETS DEPENDABILITY

2+3
YEAR | YEAR
WARRANTY



ASHBROOK



Wood



Floor

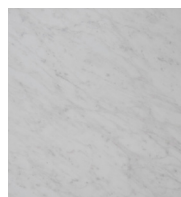

Countertop



Main Fabric



Furniture

27ASE

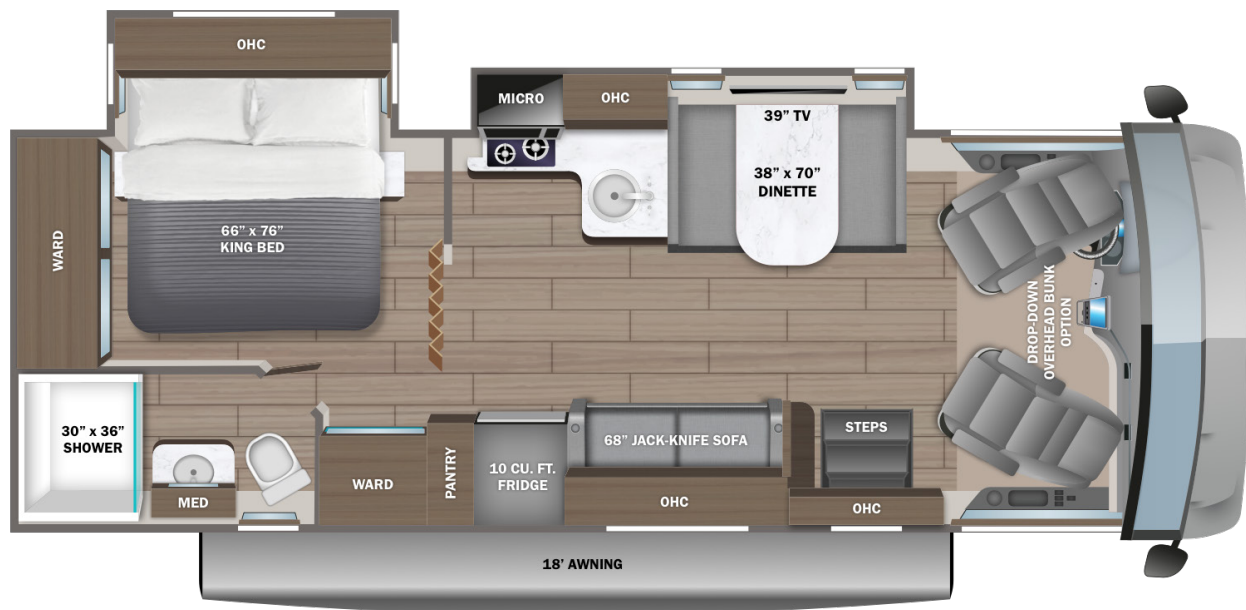

EXTERIOR SELECTIONS



Standard Graphics Package

STANDARDS & OPTIONS

CUSTOMER VALUE PACKAGE

JRide®: Computer-balanced driveshaft, jounce bumpers, heavy-duty front and rear stabilizer bars, SACHS shocks
 One-piece, seamless, crowned fiberglass roof
 Electric patio awning with LED lights
 Sony® infotainment center with Apple CarPlay® and Android Auto™
 Backup and side-view cameras
 LED HD Smart TV in living area
 Pleated blackout shades

DRIVING

Ford® F53 chassis
 GVWR - 18,000 lb.
 GCWR - 23,000 lb.
 7.3L V-8 335 HP engine with 468 ft.-lb. torque
 6-speed automatic TorqShift® transmission with overdrive and tow haul mode
 210-amp alternator
 Catalytic converter theft deterrent
 G-rated highway tires-245/70R19.5
 Front and rear disc, 4-wheel anti-lock brakes
 5,000 lb. rear hitch receiver with dual connector and 7-pin plug
 12V chassis battery
 80 gal. fuel tank
 120 in. panoramic windshield
 Swivel driver and passenger seats
 Tilt steering wheel
 Cruise control
 Hill start assist
 Electronic stability control
 Traction control
 Auxiliary start

EXTERIOR

StrongholdVBL™ roof, floor and sidewalls
 Bead-foam insulation (R-24 max roof, R-9 max floor, R-8 max walls)
 One-piece, seamless fiberglass front cap
 Fiberglass exterior walls with vinyl graphics
 Leveling jack prep
 Entrance door with industry's largest travel-view window
 Electric-powered entrance steps
 Lockable pass-through storage compartments with metal slam latches
 Third brake light
 Prep for satellite dish
 Cable TV hookup with RG-6 coax
 KING Jack™ antenna
 4,000W generator
 Solar prep
 12V house battery

Transfer switch with reverse polarity protection
 30-amp electrical service
 Detachable power cord
 16.5 gal. propane tank (56 lb.)
 LP quick-connect hookup
 Heated holding tanks (12V pads)
 Exterior utility center
 Winterization drain system
 Black tank flush
 Outside shower
 12V demand water pump
 Water filtration system

INTERIOR

Power front privacy shade with manual side privacy shades
 84 in. interior ceiling height
 High-intensity recessed LED ceiling lights
 Hardwood cabinet doors and drawer fronts
 Ball-bearing drawer guides
 15,000 BTU A/C unit
 Auto-ignition ducted furnace - 30,000 BTU
 6 gal. gas/electric DSI auto-ignition water heater
 Jayco-exclusive, easy-operation legless dinette table
 2-point lap safety belts in all designated seating locations
 Smoke alarm
 Carbon monoxide detector
 Fire extinguisher
 10 cu. ft. 12V refrigerator
 2-burner cooktop with flush cover
 Convection microwave oven
 Large stainless steel kitchen sink
 Decorative kitchen backsplash
 Walk-around, king-size bed with bedspread and nightstands
 Dual USB ports in nightstands
 Under-bed storage
 Powered roof vent in bedroom with wall switch
 Large wardrobes
 Shower with decorative surround, glass door, skylight and light
 Stainless steel bathroom sink
 Toilet with foot flush
 Powered roof vent in bathroom with wall switch

OPTIONS

Drop-down overhead bunk in cab area
 Automatic hydraulic leveling jacks

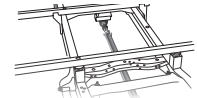

COMPUTER-BALANCED DRIVESHAFT

Ensures smooth and efficient power transfer to the wheels



JOUNCE BUMPERS

Assist during extreme road occurrences to absorb impact and dampen excess road noise

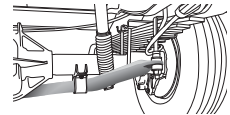

HEAVY-DUTY FRONT & REAR STABILIZER BARS

A large bar and polyurethane bushings, instead of rubber, transfer power faster for extra support, more stability and easier handling

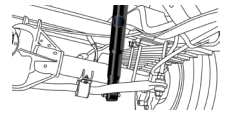

SACHS SHOCK ABSORBERS

Large-diameter tube design pairs gas and hydraulics to resist heat and pressure while independently adjusting to changing road conditions

FLOORPLAN	GVWR (lbs.)	GCWR (lbs.)	WHEEL BASE	OVERALL LENGTH	EXTERIOR HEIGHT WITH SATELLITE AND A/C	EXTERIOR WIDTH	INTERIOR HEIGHT	FRESH WATER CAPACITY (gal.)	GRAY WASTE WATER CAPACITY (gal.)	BLACK WASTE WATER CAPACITY (gal.)
27ASE	18,000	23,000	190"	29' 11"	12' 5"	101"	84"	72	50	49

Meet your Jayco Dealer



Scan QR code for specification definitions

Some specs at the time of print may include estimates. For the most updated information, please visit Jayco.com

Jayco Inc. | P.O. Box 460 | Middlebury, IN 46540

See dealer for further information and prices. All information in this brochure and on www.jayco.com is the latest available at the time of publication approval. Jayco reserves the right to make changes and to discontinue models without notice or obligation. Photography may show optional equipment or props used for decoration purposes only. RVs built for sale in Canada may differ to conform to Canadian codes. JAYCO and the JAYCO BIRD IN FLIGHT are registered trademarks of Jayco, Inc. Printed in USA 2/25 ©2025 Jayco, Inc. 2032997



Jayco - Part of Jayco Family of Companies